

Key

01A ADVANCED WARNING ACCESS TO ROAD AHEAD CLOSED ON ____ TO ____ FOR ____ DAY(S) FROM ____ TO ____	01 ROAD CLOSED	02 Diverion ENDS	04 Diverted traffic →	06 ↑ Diverted traffic	08 Diversion ←	10 ROAD AHEAD CLOSED	12 Diverted traffic ↻	14 Diverted traffic ↻	15 FOR A4130 FOLLOW DIVERSION
		03 Diverion ENDS	05 ← Diverted traffic	07 Diversion →	09 Diversion ↑	11 Diverted traffic ↻	13 Diverted traffic ↻		

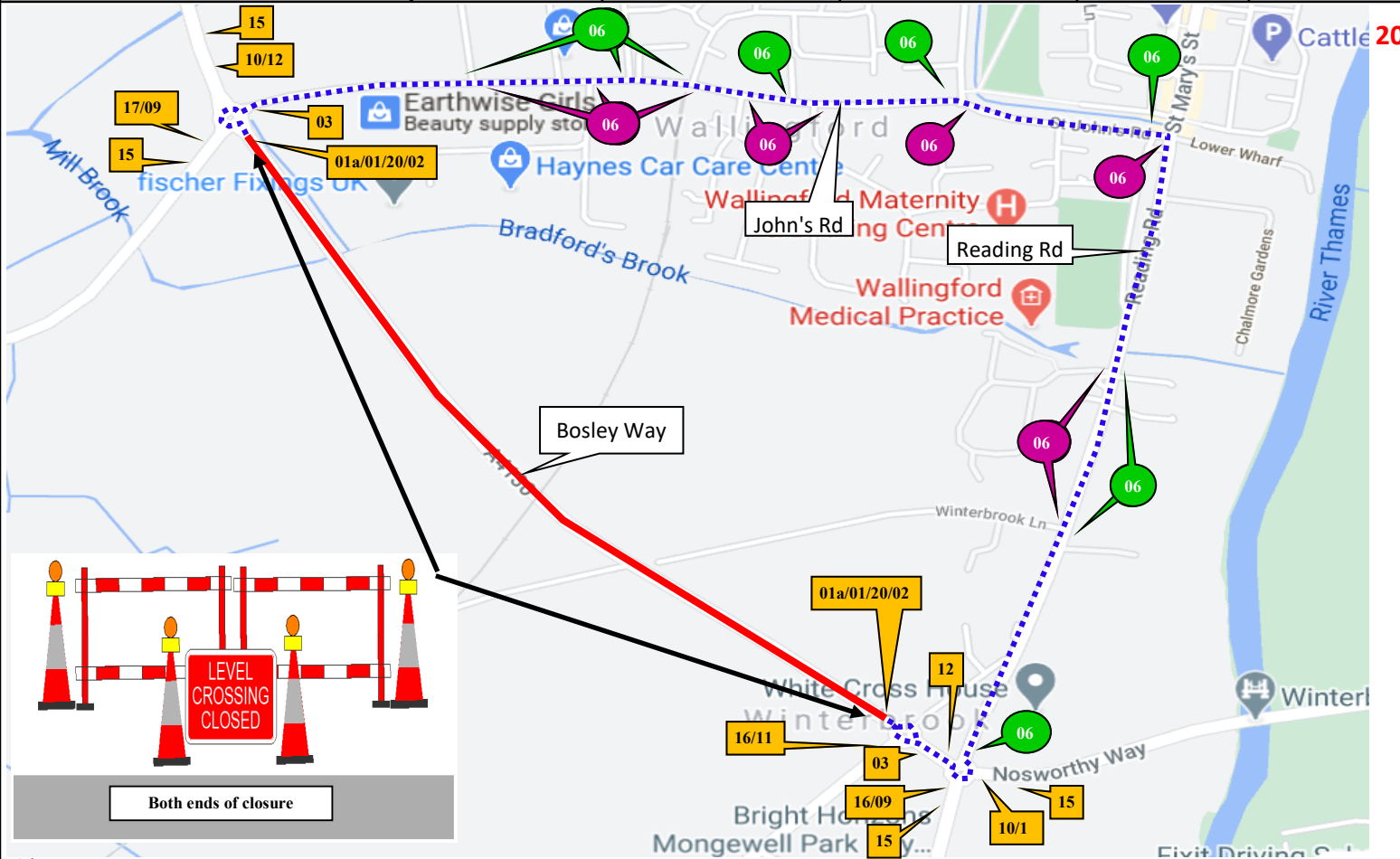

16 CYCLISTS AND PEDESTRIANS WAIT HERE TO BE ESCORTED

17 ROAD AHEAD CLOSED

18 Diverted traffic →

19 ← Diverted traffic

20 Cattle

Barriers, cones and flashing lamps required each end of road closure

rights 2021

SUNBELT RENTALS

Sunbelt Rentals UK (Traffic Management)
Kemble Airfield Enterprise Park
Cirencester Road
Kemble
GL7 6BQ
☎ 03700 500 792
📠 0845 004 7105

Note

- All equipment shall be approved and shall comply with the Department Of Transport specification MCE0111. This drawing does not show the normal road works signage that will be required as per Chapter 8.
- All signs to be in accordance with TSRGD 2016 and to minimum class retroreflective.
- Minimum height of lettering to be 60mm and sign boards to be 1000mm (750mm where appropriate).

This drawing is protected by copyright and the information contained therein is confidential.
This drawing may not be copied and the information therein may not be used, or disclosed to a third party, wholly or in part with the written permission of Sunbelt Rentals UK (Traffic Management).

CROWN COPYRIGHT DATA REPRODUCED BY PERMISSION OF THE CONTROLLER OF HMSO

CLIENT DETAILS NETWORK RAIL		REP/DEPOT DA/233	DRAWN BY DA/233	ADDRESS Bosley Way A4130 Wallingford OX10 9EL
DATE 11/10/2021	SHEET No 1 OF 1	VERSION NUMBER XXX		
AMENDED DATE Xx/xx/xxxx	AMENDED BY Xxxx-xxxx	SCALE NOT TO SCALE		
This layout is for installation by NRSWA, Lantra 12A,12B,,12D qualified persons.				BUS ROUTE AFFECTED

	ROAD CLOSURE		CLOCKWISE DIVERSION
	DIVERION		ANTI-CLOCKWISE DIVERSION
			ROAD CLOSURE SIGN
ROAD CLOSURE LENGTH (APPROX)		1380 M	
ROAD CLOSURE WIDTH (APPROX)		8 M	
Contract Number 233-S005212			